

**This electronic collection of documents is provided  
for the convenience of the user  
and is Not a Certified Document –**

**The documents contained herein were originally issued  
and sealed by the individuals whose names and license  
numbers appear on each page, on the dates appearing  
with their signature on that page.**

**This file or an individual page  
shall not be considered a certified document.**











STATE	PROJECT WBS	SHEET NUMBER
NC	2023CPT.12.11.20182	7
	2023CPT.12.11.20362	

Checked by:

Drawn by: G. Brittain

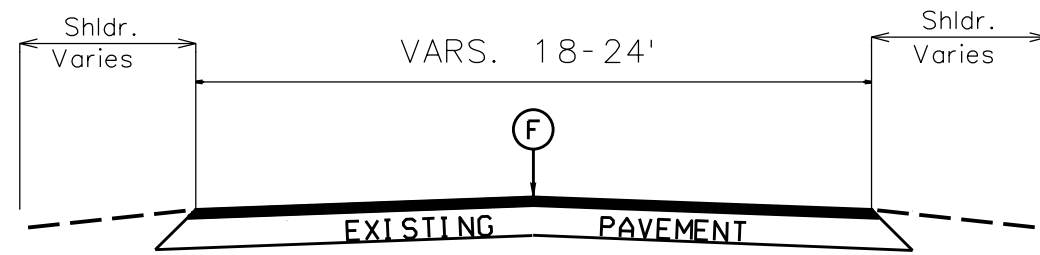

TYPICAL SECTION NO. 1  
AI I Maps

PAVEMENT SCHEDULE	
F	Latex Modified Microsurfacing Type III at an Application Rate of 22 to 26 Pounds per Square Yard

2022-2023  
PAVEMENT PRESERVATION  
GASTON AND CATAWBA  
COUNTIES

PROJECT NO.	SHEET NO.	TOTAL NO.
2023CPT.12.11.20182, 2023CPT.12.11.20362		

### SUMMARY OF QUANTITIES

PROJECT NO	COUNTY	MAP NO	ROUTE	DESCRIPTION	TYP NO	LANES	LANE TYPE	FINAL SURFACE TESTING REQUIRED	WARM MIX ASPHALT REQUIRED	LENGTH	WIDTH	1891000000-E	2143000000-E	1220000000-E
												LATEX MOD MICROSURFACE, TYPE III	BLOTTING SAND	INCIDENTAL STONE BASE
												SY	TON	TON
												MI	FT	
2023CPT.12.11.20182	Catawba	1	SR 1100 (PEA RIDGE RD)	FROM SR 1101 (ROGER HILL RD) TO LINCOLN CO	1	2	2WU	NO	NO	1.16	19	13,577		
2023CPT.12.11.20182	Catawba	2	SR 2047 (WISE RD)	FROM NC 10 TO LINCOLN CO	1	2	2WU	NO	NO	0.57	19	6,624		
2023CPT.12.11.20182	Catawba	3	SR 2063 (HOYLE RD)	FROM NC 10 TO DEAD END	1	2	2WU	NO	NO	0.72	20	8,870		
2023CPT.12.11.20182	Catawba	4	SR 1111 (JACOBS FORK RIVER RD)	FROM NC 18 TO SR 1002 (OLD SHELBY RD)	1	2	2WU	NO	NO	3.26	21	42,107	5	5
2023CPT.12.11.20182	Catawba	5	SR 1112 (FD RD)	FROM SR 1111 (JACOBS FORK RIVER RD) TO BURKE CO	1	2	2WU	NO	NO	0.88	20	10,842		
2023CPT.12.11.20182	Catawba	6	SR 1108 (LYNN MOUNTAIN RD)	FROM NC 10 TO SR 1002 (RHONEY FARM RD)	1	2	2WU	NO	NO	3.82	20	47,062	5	5
2023CPT.12.11.20182	Catawba	7	SR 1271 (GRACIE LN)	FROM NC 10 TO SR 1108 (LYNN MOUNTAIN RD)	1	2	2WU	NO	NO	1.25	20	15,400		
2023CPT.12.11.20182	Catawba	8	SR 1119 (WELDING SHOP RD)	FROM SR 1116 (PROVIDENCE CH RD) TO CUL-DE-SAC	1	2	2WU	NO	NO	0.53	20	6,841		
2023CPT.12.11.20182	Catawba	9	SR 1121 (JV PARKER DR)	FROM SR 1002 (OLD SHELBY RD) TO DEAD END	1	2	2WU	NO	NO	0.35	18	3,881		
2023CPT.12.11.20182	Catawba	10	SR 2026 (MACEDONIA CH RD)	FROM SR 2036 (PLATEAU RD) TO SR 2024 (REEPSVILLE RD)	1	2	2WU	NO	NO	2.92	18	32,377	5	5
2023CPT.12.11.20182	Catawba	11	SR 2008 (BIGGERSTAFF RD)	FROM SR 1005 (STARTOWN RD) TO LINCOLN CO	1	2	2WU	NO	NO	0.91	20	11,211		
2023CPT.12.11.20182	Catawba	12	SR 2007 (W MAIDEN RD)	FROM SR 1005 (STARTOWN RD) TO CUL-DE-SAC	1	2	2WU	NO	NO	0.47	20	5,956		
2023CPT.12.11.20182	Catawba	13	SR 1867 (JIM BEARD RD)	FROM SR 1855 (E MAIDEN RD) TO SR 1874 (WATER PLANT RD)	1	2	2WU	NO	NO	1.49	19	17,439		
2023CPT.12.11.20182	Catawba	14	SR 1859 (JOE CROUSE RD)	FROM SR 1858 (S OLIVERS X RD) TO SR 1860 (LANEY RD)	1	2	2WU	NO	NO	1.08	18	11,975		
2023CPT.12.11.20182	Catawba	15	SR 1728 (JB RD)	FROM SR 1722 (OLD CATAWBA RD) TO DEAD END	1	2	2WU	NO	NO	0.95	20	11,500		
2023CPT.12.11.20182	Catawba	16	SR 1824 (HARWELL RD)	FROM SR 1822 (LOWRANCE RD) TO DEAD END	1	2	2WU	NO	NO	1.18	18	13,556		
2023CPT.12.11.20182	Catawba	17	SR 1823 (ALLEY RD)	FROM SR 1848 (SHERRILLS FORD RD) TO END MAINT	1	2	2WU	NO	NO	0.87	20	10,718		
<b>TOTAL FOR PROJ NO. 2023CPT.12.11.20182</b>										<b>22.41</b>		<b>269,936</b>	<b>15</b>	<b>15</b>
2023CPT.12.11.20362	Gaston	18	SR 1426 (PAUL H BEAM RD)	FROM NC 150 TO CLEVELAND CO	1	2	2WU	NO	NO	0.93	18	10,312		
2023CPT.12.11.20362	Gaston	19	SR 1422 (CAROL RD)	FROM SR 1421 (MARY'S GROVE RD) TO BRIDGE	1	2	2WU	NO	NO	0.45	18	4,990		
2023CPT.12.11.20362	Gaston	20	SR 1626 (SUN BEAM FARM RD)	FROM NC 279 TO SR 1438 (ST MARKS CH RD)	1	2	2WU	NO	NO	1.42	18	15,745		
2023CPT.12.11.20362	Gaston	21	SR 1608 (LONG SHOALS RD/ OLD NC 277)	FROM NC 279 TO NC 279	1	2	2WU	NO	NO	0.50	19	5,852		
2023CPT.12.11.20362	Gaston	22	SR 1439 (SHORT RD)	FROM SR 1440 (TRYON SCHOOL RD) TO DEAD END	1	2	2WU	NO	NO	0.50	18	5,544		
2023CPT.12.11.20362	Gaston	23	SR 1447 (ABEL RD)	FROM SR 1446 (BESSTOWN RD) TO SR 1443 (DAMERON RD)	1	2	2WU	NO	NO	1.00	20	12,320		
2023CPT.12.11.20362	Gaston	24	SR 1446 (BESSTOWN RD)	FROM PVMT JOINT TO SR 1447 (ABEL RD)	1	2	2WU	NO	NO	2.06	19	24,110	5	5
2023CPT.12.11.20362	Gaston	25	SR 1410 (WEAVER DAIRY RD)	FROM SR 1409 (SUNNY SIDE SHADY REST RD) TO SR 1412 (EAKER RD)	1	2	2WU	NO	NO	1.43	19	16,737		
2023CPT.12.11.20362	Gaston	26	SR 1411 (NEAL RD)	FROM SR 1409 (SUNNY SIDE SHADY REST RD) TO SR 1412 (EAKER RD)	1	2	2WU	NO	NO	1.17	19	13,694		
2023CPT.12.11.20362	Gaston	27	SR 1413 (BESS RD)	FROM NC 216 TO SR 1412 (EAKER RD)	1	2	2WU	NO	NO	1.14	19	13,343		
2023CPT.12.11.20362	Gaston	28	SR 1116 (MOUNTAIN CREST DR)	FROM SR 2292 (LAKE MONTONIA RD) TO SR 2292 (LAKE MONTONIA RD)	1	2	2WU	NO	NO	1.01	24	14,932		
2023CPT.12.11.20362	Gaston	29	SR 1124 (BREVARD ST)	FROM SR 1125 (SPARROW SPRINGS RD) TO DEAD END	1	2	2WU	NO	NO	0.47	20	5,790		
2023CPT.12.11.20362	Gaston	30	SR 1126 (OLD PROVIDENCE RD)	FROM SR 1128 (CHAPEL GROVE RD) TO DEAD END	1	2	2WU	NO	NO	0.64	19	7,491		
2023CPT.12.11.20362	Gaston	31	SR 1106 (FREEDOM MILL RD)	FROM SR 1126 (LEWIS RD) TO SR 1103 (CROWDER'S CREEK RD)	1	2	2WU	NO	NO	1.25	21	16,170		
2023CPT.12.11.20362	Gaston	32	SR 1107 (CROWDER CREEK CH RD)	FROM SR 1103 (CROWDER'S CREEK RD) TO END MAINT	1	2	2WU	NO	NO	0.56	18	6,209		
2023CPT.12.11.20362	Gaston	33	SR 1102 (UNITY CHURCH RD)	FROM SR 1103 (CROWDER'S CREEK RD) TO SR 1112 (LEWIS RD)	1	2	2WU	NO	NO	0.87	19	10,182		
2023CPT.12.11.20362	Gaston	34	SR 1614 (GASTON HILLSIDE DR)	FROM LINCOLN CO TO END MAINT	1	2	2WU	NO	NO	0.29	20	3,573		
2023CPT.12.11.20362	Gaston	35	SR 1827 (MAYBERRY RD)	FROM SR 1823 (MAUNEY RD) TO SR 1826 (CHARLOTTE ST)	1	2	2WU	NO	NO	2.39	19	28,000	5	5
2023CPT.12.11.20362	Gaston	36	SR 1453 (JOE CLONINGER RD)	FROM SR 1452 (COSTNER SCHOOL RD) TO SR 1452 (COSTNER SCHOOL RD)	1	2	2WU	NO	NO	1.58	20	19,466		
<b>TOTAL FOR PROJ NO. 2023CPT.12.11.20362</b>										<b>19.66</b>		<b>234,460</b>	<b>10</b>	<b>10</b>
<b>GRAND TOTAL</b>										<b>42.07</b>		<b>504,396</b>	<b>25</b>	<b>25</b>



PROJECT NO.	SHEET NO.	TOTAL NO.
2023CPT.12.11.20182, 2023CPT.12.11.20362		

### THERMOPLASTIC AND PAINT QUANTITIES

PROJECT NO	COUNTY	MAP NO	ROUTE	DESCRIPTION	TYP NO	LANES	LANE TYPE	LENGTH	WIDTH	4457000000-N	4413000000-E	4704000000-E	4709000000-E	4720000000-E	4810000000-E		4870000000-E	4875000000-N				
										TEMPORARY TRAFFIC CONTROL	WORK ZONE / ADVANCE WARNING SIGNS	THERMOPLASTIC PAVEMENT MARKING LINES WHITE (16", 90 MILS)	THERMOPLASTIC PAVEMENT MARKING LINES WHITE (24", 90 MILS)	THERMOPLASTIC PAVEMENT MARKING CHARACTER (90 MILS)	4" YELLOW PAINT	4" WHITE PAINT	24" LINE REMOVAL	REMOVAL OF PAVEMENT MARKING SYMBOLS & CHARACTERS				
										LS	SF	LF	LF	EA	LF	LF	LF	EA				
2023CPT.12.11.20182	Catawba	1	SR 1100 (PEA RIDGE RD)	FROM SR 1101 (ROGER HILL RD) TO LINCOLN CO	1	2	2WU	1.16	19	*	118					24,600	24,600					
2023CPT.12.11.20182	Catawba	2	SR 2047 (WISE RD)	FROM NC 10 TO LINCOLN CO	1	2	2WU	0.57	19	*	96					12,000	12,000					
2023CPT.12.11.20182	Catawba	3	SR 2063 (HOYLE RD)	FROM NC 10 TO DEAD END	1	2	2WU	0.72	20	*	96											
2023CPT.12.11.20182	Catawba	4	SR 1111 (JACOBS FORK RIVER RD)	FROM NC 18 TO SR 1002 (OLD SHELBY RD)	1	2	2WU	3.26	21	*	182					68,750	68,750					
2023CPT.12.11.20182	Catawba	5	SR 1112 (FD RD)	FROM SR 1111 (JACOBS FORK RIVER RD) TO BURKE CO	1	2	2WU	0.88	20	*	96					18,600	18,600					
2023CPT.12.11.20182	Catawba	6	SR 1108 (LYNN MOUNTAIN RD)	FROM NC 10 TO SR 1002 (RHONEY FARM RD)	1	2	2WU	3.82	20	*	182					80,700	80,700					
2023CPT.12.11.20182	Catawba	7	SR 1271 (GRACIE LN)	FROM NC 10 TO SR 1108 (LYNN MOUNTAIN RD)	1	2	2WU	1.25	20	*	118					26,400	26,400					
2023CPT.12.11.20182	Catawba	8	SR 1119 (WELDING SHOP RD)	FROM SR 1116 (PROVIDENCE CH RD) TO CUL-DE-SAC	1	2	2WU	0.53	20	*	96					11,200	11,200					
2023CPT.12.11.20182	Catawba	9	SR 1121 (JV PARKER DR)	FROM SR 1002 (OLD SHELBY RD) TO DEAD END	1	2	2WU	0.35	18	*	96											
2023CPT.12.11.20182	Catawba	10	SR 2026 (MACEDONIA CH RD)	FROM SR 2036 (PLATEAU RD) TO SR 2024 (REEPSVILLE RD)	1	2	2WU	2.92	18	*	182					61,700	61,700					
2023CPT.12.11.20182	Catawba	11	SR 2008 (BIGGERSTAFF RD)	FROM SR 1005 (STARTOWN RD) TO LINCOLN CO	1	2	2WU	0.91	20	*	96					19,250	19,250					
2023CPT.12.11.20182	Catawba	12	SR 2007 (W MAIDEN RD)	FROM SR 1005 (STARTOWN RD) TO CUL-DE-SAC	1	2	2WU	0.47	20	*	96					10,000	10,000					
2023CPT.12.11.20182	Catawba	13	SR 1867 (JIM BEARD RD)	FROM SR 1855 (E MAIDEN RD) TO SR 1874 (WATER PLANT RD)	1	2	2WU	1.49	19	*	118					31,500	31,500					
2023CPT.12.11.20182	Catawba	14	SR 1859 (JOE CROUSE RD)	FROM SR 1858 (S OLIVERS X RD) TO SR 1860 (LANEY RD)	1	2	2WU	1.08	18	*	118					22,750	22,750					
2023CPT.12.11.20182	Catawba	15	SR 1728 (JB RD)	FROM SR 1722 (OLD CATAWBA RD) TO DEAD END	1	2	2WU	0.95	20	*	96					20,000	20,000					
2023CPT.12.11.20182	Catawba	16	SR 1824 (HARWELL RD)	FROM SR 1822 (LOWRANCE RD) TO DEAD END	1	2	2WU	1.18	18	*	118					24,700	24,700					
2023CPT.12.11.20182	Catawba	17	SR 1823 (ALLEY RD)	FROM SR 1848 (SHERRILLS FORD RD) TO END MAINT	1	2	2WU	0.87	20	*	96					18,400	18,400					
<b>TOTAL FOR PROJ NO. 2023CPT.12.11.20182</b>																<b>450,550</b>	<b>450,550</b>					
															<b>901,100</b>							
2023CPT.12.11.20362	Gaston	18	SR 1426 (PAUL H BEAM RD)	FROM NC 150 TO CLEVELAND CO	1	2	2WU	0.93	18	*	96	80	60	4	19,650	19,650	60	4				
2023CPT.12.11.20362	Gaston	19	SR 1422 (CAROL RD)	FROM SR 1421 (MARY'S GROVE RD) TO BRIDGE	1	2	2WU	0.45	18	*	96				9,510	9,510						
2023CPT.12.11.20362	Gaston	20	SR 1626 (SUN BEAM FARM RD)	FROM NC 279 TO SR 1438 (ST MARKS CH RD)	1	2	2WU	1.42	18	*	118				30,000	30,000						
2023CPT.12.11.20362	Gaston	21	SR 1608 (LONG SHOALS RD/ OLD NC 277)	FROM NC 279 TO NC 279	1	2	2WU	0.50	19	*	96				10,560	10,560						
2023CPT.12.11.20362	Gaston	22	SR 1439 (SHORT RD)	FROM SR 1440 (TRYON SCHOOL RD) TO DEAD END	1	2	2WU	0.50	18	*	96											
2023CPT.12.11.20362	Gaston	23	SR 1447 (ABEL RD)	FROM SR 1446 (BESSTOWN RD) TO SR 1443 (DAMERON RD)	1	2	2WU	1.00	20	*	96				21,120	21,120						
2023CPT.12.11.20362	Gaston	24	SR 1446 (BESSTOWN RD)	FROM PVMT JOINT TO SR 1447 (ABLE RD)	1	2	2WU	2.06	19	*	182				43,510	43,510						
2023CPT.12.11.20362	Gaston	25	SR 1410 (WEAVER DAIRY RD)	FROM SR 1409 (SUNNY SIDE SHADY REST RD) TO SR 1412 (EAKER RD)	1	2	2WU	1.43	19	*	118				30,200	30,200						
2023CPT.12.11.20362	Gaston	26	SR 1411 (NEAL RD)	FROM SR 1409 (SUNNY SIDE SHADY REST RD) TO SR 1412 (EAKER RD)	1	2	2WU	1.17	19	*	118				24,710	24,710						
2023CPT.12.11.20362	Gaston	27	SR 1413 (BESS RD)	FROM NC 216 TO SR 1412 (EAKER RD)	1	2	2WU	1.14	19	*	118				24,100	24,100						
2023CPT.12.11.20362	Gaston	28	SR 1116 (MOUNTAIN CREST DR)	FROM SR 2292 (LAKE MONTONIA RD) TO SR 2292 (LAKE MONTONIA RD)	1	2	2WU	1.01	24	*	118				21,250	21,250						
2023CPT.12.11.20362	Gaston	29	SR 1124 (BREVARD ST)	FROM SR 1125 (SPARROW SPRINGS RD) TO DEAD END	1	2	2WU	0.47	20	*	96				9,950	9,950						
2023CPT.12.11.20362	Gaston	30	SR 1126 (OLD PROVIDENCE RD)	FROM SR 1128 (CHAPEL GROVE RD) TO DEAD END	1	2	2WU	0.64	19	*	96				13,520	13,520						
2023CPT.12.11.20362	Gaston	31	SR 1106 (FREEDOM MILL RD)	FROM SR 1126 (LEWIS RD) TO SR 1103 (CROWDER'S CREEK RD)	1	2	2WU	1.25	21	*	118				26,400	26,400						
2023CPT.12.11.20362	Gaston	32	SR 1107 (CROWDER CREEK CH RD)	FROM SR 1103 (CROWDER'S CREEK RD) TO END MAINT	1	2	2WU	0.56	18	*	96											
2023CPT.12.11.20362	Gaston	33	SR 1102 (UNITY CHURCH RD)	FROM SR 1103 (CROWDER'S CREEK RD) TO SR 1112 (LEWIS RD)	1	2	2WU	0.87	19	*	96				18,375	18,375						
2023CPT.12.11.20362	Gaston	34	SR 1614 (GASTON HILLSIDE DR)	FROM LINCOLN CO TO END MAINT	1	2	2WU	0.29	20	*	96				6,125	6,125						
2023CPT.12.11.20362	Gaston	35	SR 1827 (MAYBERRY RD)	FROM SR 1823 (MAUNEY RD) TO SR 1826 (CHARLOTTE ST)	1	2	2WU	2.39	19	*	182				50,475	50,475						
2023CPT.12.11.20362	Gaston	36	SR 1453 (JOE CLONINGER RD)	FROM SR 1452 (COSTNER SCHOOL RD) TO SR 1452 (COSTNER SCHOOL RD)	1	2	2WU	1.58	20	*	118				33,375	33,375						
<b>TOTAL FOR PROJ NO. 2023CPT.12.11.20362</b>												<b>80</b>	<b>60</b>	<b>4</b>	<b>392,830</b>	<b>392,830</b>	<b>60</b>	<b>4</b>				
															<b>785,660</b>							
<b>GRAND TOTAL</b>												<b>42.07</b>		<b>1</b>	<b>4,150</b>	<b>80</b>	<b>60</b>	<b>4</b>	<b>843,380</b>	<b>843,380</b>	<b>60</b>	<b>4</b>
															<b>1,686,760</b>							

# SIGNING FOR ASPHALT SURFACE TREATMENT

**LEGEND**

- ▷ PORTABLE SIGN
- └ STATIONARY SIGN
- ← DIRECTION OF TRAFFIC FLOW

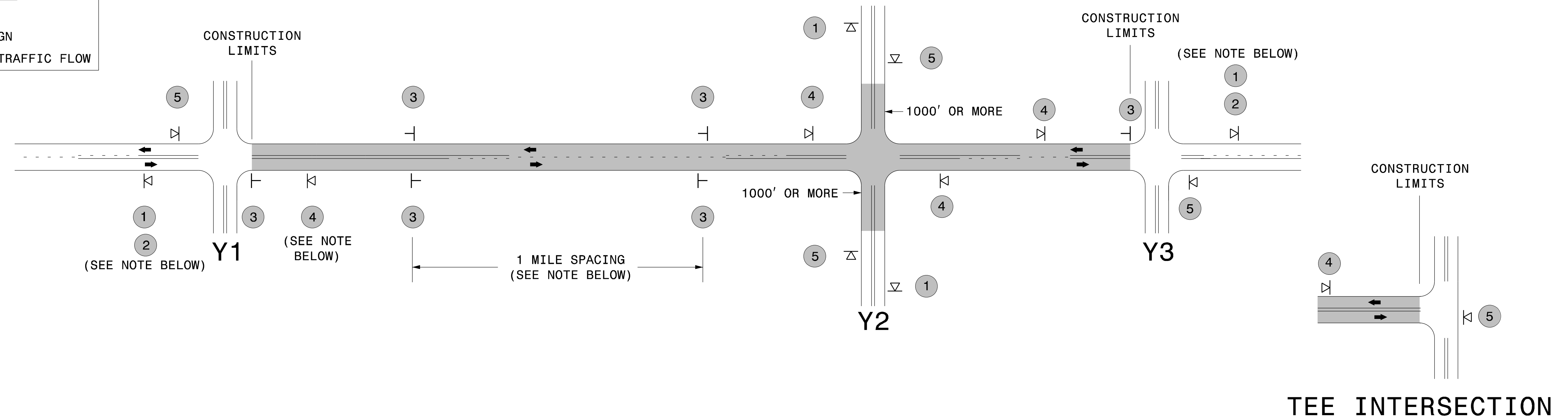

## MAINLINE (-L-) SIGNING

## -Y- LINE SIGNING

SIGNING NOTES AND PLACEMENT PER DIRECTION		<ul style="list-style-type: none"> <li>- PLACE 1000' PRIOR TO BEGINNING OF CONSTRUCTION LIMITS. ONLY USED ON -Y- LINES IF RESURFACING LIMITS EXTEND 1000' ALONG -Y- LINE.</li> <li>- SIGN #2 ONLY USED WHEN RESURFACING LIMITS ARE 2 OR MORE MILES IN LENGTH. ROUND UP TO THE NEAREST WHOLE NUMBER. DO NOT USE FRACTIONAL OR DECIMAL NUMBERS.</li> </ul>	<p>STATIONARY SIGNING NOT REQUIRED FOR THE FOLLOWING -Y- LINE CONDITIONS:</p> <ol style="list-style-type: none"> <li>1) LESS THAN 1000' OF RESURFACING ALONG -Y- LINE</li> <li>2) SUBDIVISION ROADS</li> <li>3) DEAD END ROADS</li> </ol> <p>WHEN PAVING/CONSTRUCTION ACTIVITIES PROCEED ACROSS AN UNSIGNED -Y- LINE, PORTABLE ADVANCE WARNING SIGNS SHALL BE USED ALONG THE -Y- LINE AS SHOWN BELOW. REMOVE UPON COMPLETION OF WORK.</p> <div style="display: flex; justify-content: space-around;"> <div style="text-align: center;"> <p>PLACED 500' IN ADVANCE OF FLAGGER.</p> </div> <div style="text-align: center;"> <p>PLACED 250' IN ADVANCE OF FLAGGER.</p> </div> </div>
		<ul style="list-style-type: none"> <li>- ALTERNATE THE FOLLOWING TWO SIGNS:</li> <li>- STARTING WITH "LOOSE GRAVEL" (W8-7) FOLLOWED BY "UNMARKED PAVEMENT".</li> <li>- PLACE INITIALLY AT THE CONSTRUCTION LIMITS AND SPACED 1 MILE APART THEREAFTER.</li> <li>- AT TEE INTERSECTIONS INSTALL INITIALLY 0.5 MILE FROM INTERSECTION AND SPACE 1 MILE APART THEREAFTER.</li> </ul>	
		<ul style="list-style-type: none"> <li>- THESE ARE FOR -Y- LINES THAT ARE "THROUGH" ROADWAYS. DEAD END AND SUBDIVISION ROADS ARE NOT "THROUGH" ROADWAYS.</li> <li>- INSTALL 500' +/- FROM EACH -Y- LINE APPROACH AS SHOWN ABOVE.</li> <li>- FOR MULTIPLE -Y- LINES THAT ARE SEPARATED BY 0.25 MILES OR LESS, TREAT AS A SINGLE UNIT AND INSTALL WITHIN 500' OF EACH APPROACH.</li> <li>- A MAXIMUM OF 2 SIGN SETS PER MILE. DO NOT INSTALL WHEN -Y- LINES ARE WITHIN 0.5 MILES FROM "END ROAD WORK" SIGN.</li> </ul>	
		<ul style="list-style-type: none"> <li>- PLACE 500' FOLLOWING THE END OF CONSTRUCTION LIMITS OR AS SHOWN WHEN WORK ENDS AT A 3-WAY TEE INTERSECTION.</li> </ul>	
	<p>THE ABOVE SIGNS ARE ALL THAT ARE REQUIRED FOR A CONTRACTOR TO BEGIN A RESURFACING CONTRACT. ANY ADDITIONAL SIGNS REQUESTED BY NCDOT DIVISIONS SHALL BE INSTALLED WITHIN 7 BUSINESS DAYS OF THE START OF CONTRACT WORK.</p>		

**MAPS LESS THAN 2 MILES**

FOR AST RESURFACING MAPS WITH CONSTRUCTION LIMITS LESS THAN 2 MILES IN LENGTH, USE A STATIONARY "LOOSE GRAVEL" SIGN AT THE BEGINNING CONSTRUCTION LIMIT FOLLOWED BY AN "UNMARKED PAVEMENT" SIGN MIDWAY THROUGH AND AN "END ROAD WORK" SIGN AT THE END CONSTRUCTION LIMIT.

**ADVANCE WARNING SIGNS FOR 2-LANE ROADWAY ASPHALT SURFACE TREATMENT**